

Espay Solar Energy S.L.

How big a battery cabinet should I use for a 200ah battery



Overview

Find the ideal battery bank size for your energy needs. Enter your energy consumption and backup requirements to determine the best battery size in ampere-hours or watt-hours. This comprehensive guide explores what defines a reliable battery storage solution, why battery hazards occur, and how different design features—such as. Battery banks must be sized based on load, autonomy time, depth of discharge, and cycle life. This video explains why 200Ah does not equal 200Ah usable and how professionals design battery systems. The. Your primary use case should drive capacity decisions, not maximum theoretical needs. Usable capacity differs from total capacity: Lithium batteries provide 90-95% usable capacity while lead-acid only offers 50%.

How big a battery cabinet should I use for a 200ah battery



How to Size Your Battery Bank Properly (200Ah Explained)

Battery banks must be sized based on load, autonomy time, depth of discharge, and cycle life. This video explains why 200Ah does not equal 200Ah usable and how professionals design battery systems

How to Properly Size and Install Lithium-Ion Rack

Lithium-ion rack battery systems are crucial for energy storage in various applications, including data centers, telecommunications, and emergency response. Proper sizing and installation are essential to maximize their ...



Why You Should Consider a 200Ah Battery Cabinet for Your Energy Needs

Consider how much power you will need and for how long. This will help you determine if a 200Ah capacity is sufficient for your situation. Different types of batteries (like lead-acid, lithium-ion, etc.) have ...

BESS CABINET

A BESS cabinet (Battery Energy Storage System cabinet) is no longer just a "battery box." In modern commercial and industrial (C& I) projects, it is a full energy asset --designed to reduce electricity costs, ...



How Much Battery Storage Do I Need? Complete 2025 Sizing Guide

Calculate exactly how much battery storage you need for backup power, bill savings, or off-grid living. Free calculator + expert sizing guide included.

The Complete Guide to Choosing a Safe and Reliable Battery Storage Cabinet

Learn everything about choosing a safe, compliant, and effective battery storage cabinet. Explore features, risks, maintenance practices, cabinet types, and essential safety considerations for lithium-ion ...



How to Choose the Right Battery Cabinet for Your Needs

Choosing the right battery cabinet involves careful consideration of your



needs, safety features, build quality, and maintenance. Think about how the cabinet will be used, and don't hesitate to consult ...

Battery Bank Size Calculator

Find the ideal battery bank size for your energy needs. Enter your energy consumption and backup requirements to determine the best battery size in ampere-hours or watt-hours.

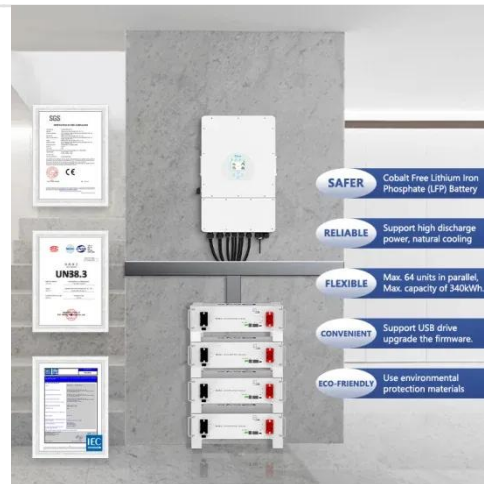

How to Right-Size Your Battery Storage System

Proper battery sizing depends on several factors: how much electricity is needed to keep devices powered, how long those devices will rely on stored energy, and the actual capacity of each battery pack. The first step, ...

Maximize Safety and Space: The Essential Guide to Battery Storage Cabinets

Determine Battery Type: Select a cabinet that accommodates the specific

batteries you use, paying attention to size and chemical compatibility. Assess Space Availability: Measure the area where the ...



Contact Us

For catalog requests, pricing, or partnerships, please visit:
<https://www.espay.es>

